



FendtONE onboard Software Version Nov. 2025

November 2025

FendtONE Software Update overview

FendtONE driver's workplace
Available from: November 2025

How can the current software version be viewed on the FendtONE terminal?

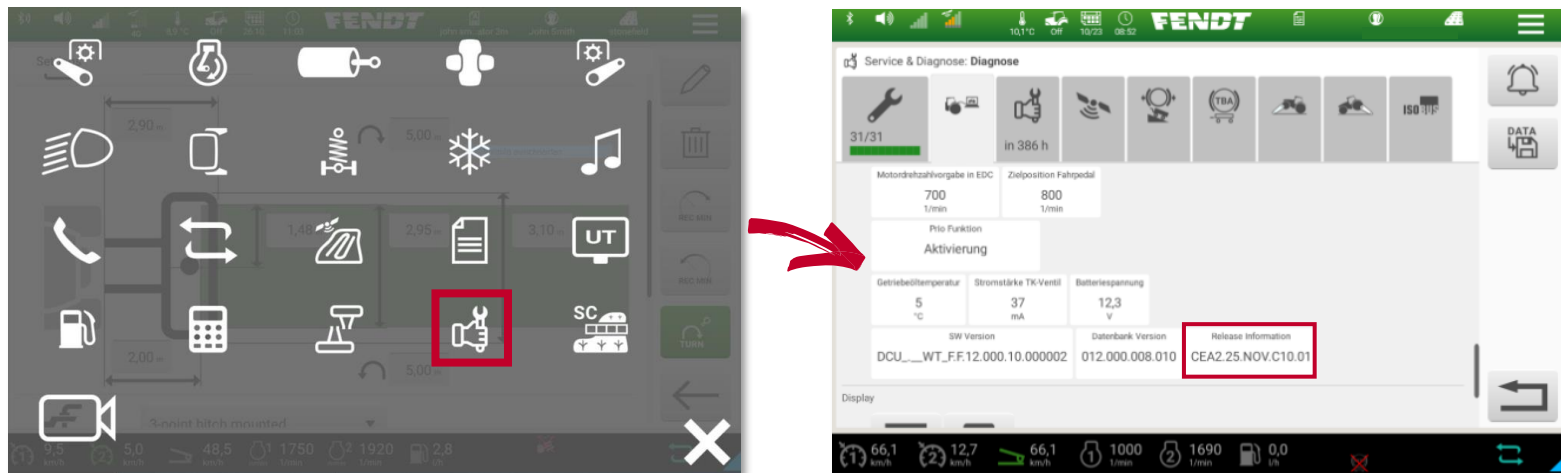

CEA2: Electronic Architecture Version

25: Year 2025

NOV: Release Month (November)

C10.01: Sequential Version



Fendt Guidance: Innovations and Improvements

Headland management – headland around obstacles

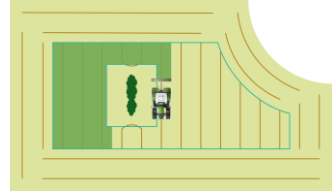

Description

Whether trees, waterholes, flower strips, buildings - obstacles in the field are currently interfering with the consistent use of work simplifications in the field such as Section Control and TI Auto. The new possibility of creating a simple or extended headland line in the field allows the advantages of site-specific work to be transferred to flowering strips in the field, for example. The application of plant protection products via protection zones is omitted. In addition, TI Auto, the automatic playback of the TI sequence at the headland line in the field, takes place.

When setting the headland, the range of functions of the Simple and Extended Headlands can also be carried out at internal field boundaries around obstacles. Automatic turning (TI Turn Assistant) is not available for internal headland lines.

Further Information

- Available from EOL Nov 2025
- Required sales codes: generally none; E116 (TI Headland) for TI Auto, C257 for Section Control
- Price: No extra charge, software only, for terminals

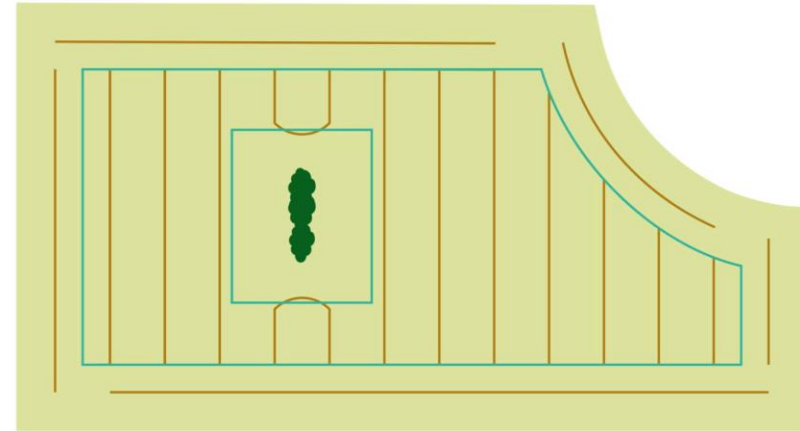

Guidance (1)

Alphabetical Order Waylines

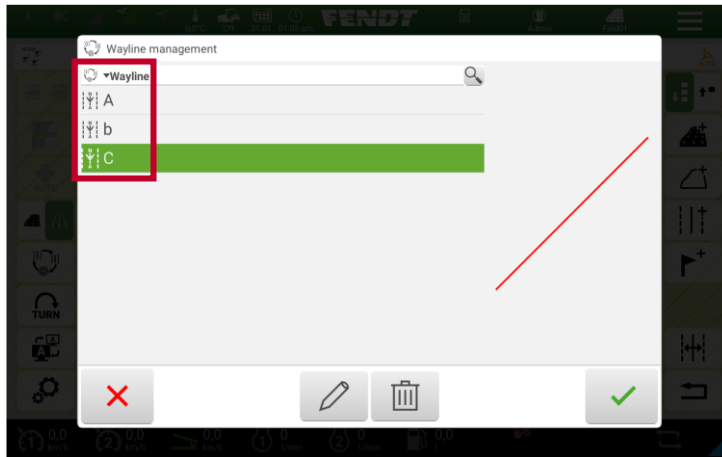

November 2025

Previously, the default order of waylines within the Wayline management was based on the time they were created or imported.

With a new software update, track lines are sorted alphabetically – ascending or descending.

Wayline naming with time stamp

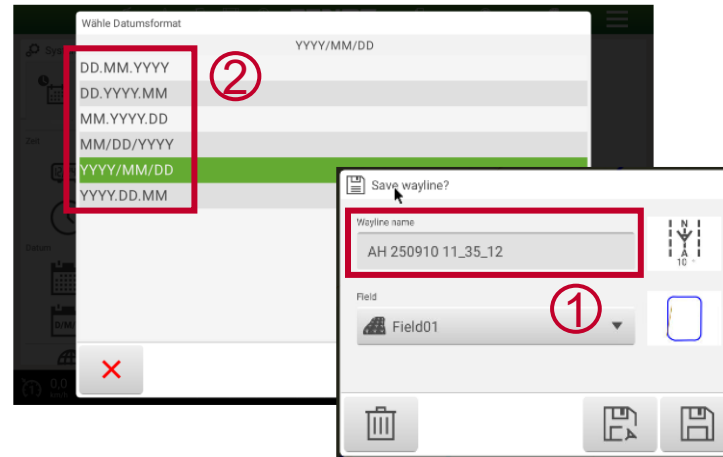

November 2025

Date/time settings are used to suggest a default name for waylines (1).

Until now, only the standard name YYMMDD was available globally. Example: 250910 for September 10, 2025.

With the new software update, drivers can choose from five additional date formats (2), which makes the automatic naming of track lines easier to understand.

TI Turn Assistant | Enhancement icon

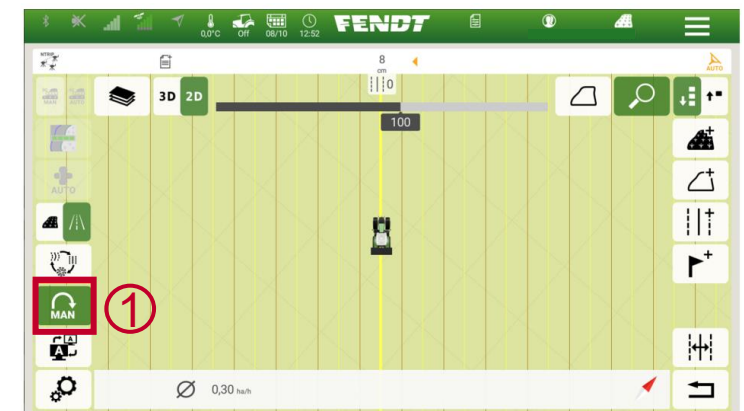

November 2025

The (1) "Auto/Manual Turn" button in the Guide map view now shows the status "Auto/Manual Turn" highlighted in green without the driver having to click on the (1) button.

Guidance (2)

Reduced Pop-up | Notification Center

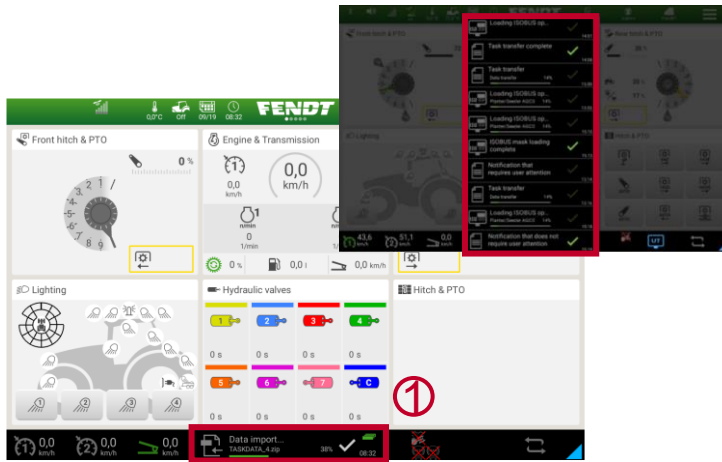

November 2025

Due to this innovation, pop-ups will no longer appear in the terminal in the future when new field data is available, which would be extremely annoying for the driver when synchronizing automatically with FMIS solutions.

Instead, the updates are bundled in a notification center (1), where it is possible to track which updates arrived WITHOUT interrupting the driver while working.

Improvement of boundary from contour segments

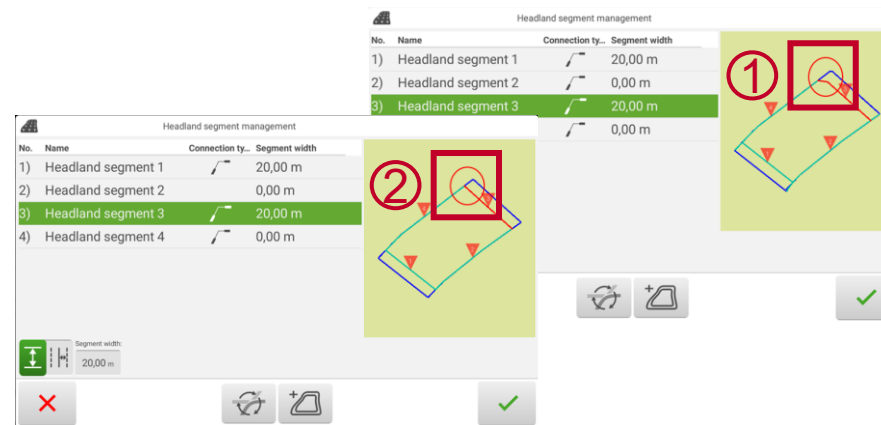

November 2025

By improving the calculation of boundaries from contour segments, inaccuracies (1) are automatically corrected by algorithms (2).

The defects (3) that have previously occurred when calculating field boundaries from contour segments, for example, are detected with a new software update, whereby the field boundary sketched in turquoise is calculated.



Guidance (3)

Improvement of NovAtel and Trimble receivers*



November 2025

The software update provides an overall improvement in RTK performance for the NovAtel Smart 7 and Trimble AG 482 receivers, especially during ionospheric disturbances caused by global solar storms.

For farmers and contractors who have installed the NovAtel Smart 7 or Trimble AG 482 receiver, operational reliability and stability are improved.

*except South America.

Feedback man. switch SBAS satellites

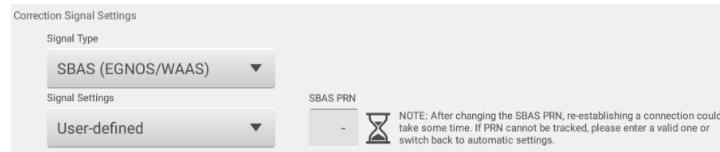

November 2025

Feedback when manually changing an SBAS satellite. A note has been added for the operator to inform him that a delay is to be expected when manually changing SBAS satellites. The default setting is still automatic satellite selection.

Manual selection of mobile networks

November 2025

The driver can choose between automatic selection of the mobile network and fixed technology 2G, 3G or 4G.

The option of a fixed technology can provide more stability in areas where the cellular modem switches between the different cellular technologies too often.

Guidance (4)

Free Map Navigation

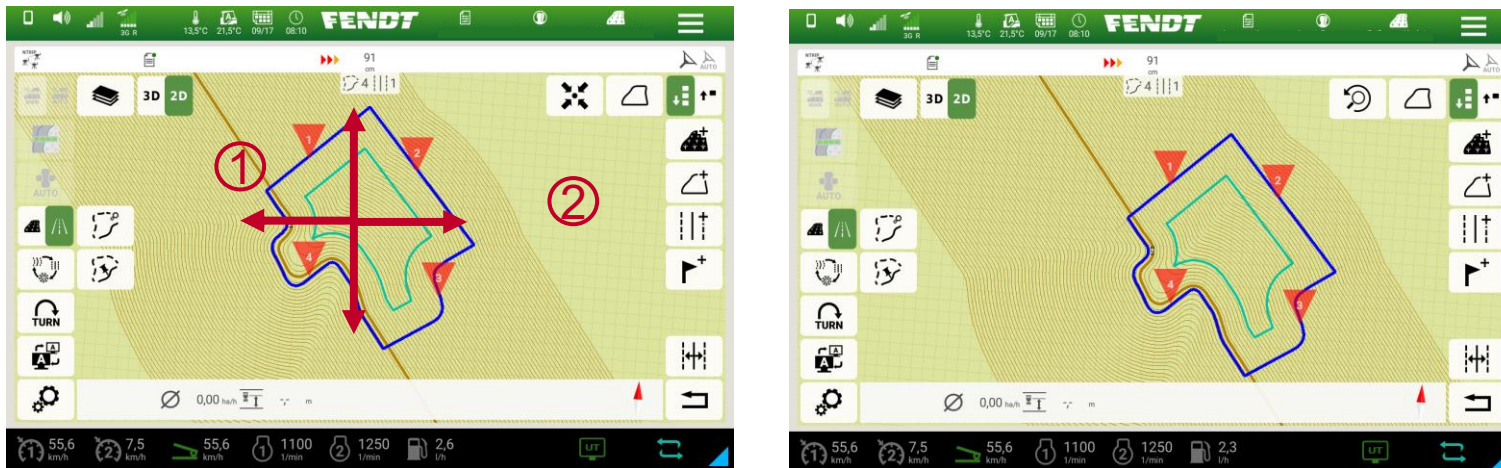

November 2025

With the software update, the map view in the Guide menu on the terminal can be moved and enlarged more intuitively with one/two fingers (1). With "Map Move" and "Pinch to Scale", Fendt drivers benefit from a more intuitive use of the map view in the Guide Menu by operating a touchscreen analogous to the use of smart devices.

For better clarity, a maximum of 100 lines are displayed (50 left and 50 right) (2). In reality, the lines are multiplied an infinite number of times.

New area calculation



November 2025

A new info button (1) takes Fendt drivers to more area calculation related information (e.g. Showing the ratio of headland to field size) to different area measurements in the selected field.

So far, only the entire area (2) of a field is displayed and used for area settings. With the software update, the editable area (4) is calculated, which corresponds to the total area (2) minus the obstacle area (3).

Guidance (5)

New 800 Vario | High Speed Guidance

November 2025

Optional increase of the maximum speed in guidance applications from 25km/h to 40km/h.

Use cases e.g.:

- NA/ ANZ Crop Care - Trailed sprayers, spreading lime and granular fertilizer
- FR – Manure Spreading

The increase to 40 km/h must be validated individually for each model series: Currently, "High Speed Guidance" is only available for the new 800 Series. In the next step, High Speed Guidance will be gradually validated and rolled out on other model series.



Machine control (ISOBUS): Improvements

Machine control (1)

TIM – PTO Speed

November 2025

TIM PTO Speed extends the functionality of TIM (Tractor Implement Management) by automatically regulating the PTO speed within the PTO speed level selected by the driver, so that it optimally meets the requirements of the implement used.

TIM PTO Speed supports uniform baling density and size, especially in different field conditions. During crop protection work, the automatic PTO speed optimises the pressure and the correct flow rate for resource-saving application of operating fluids.

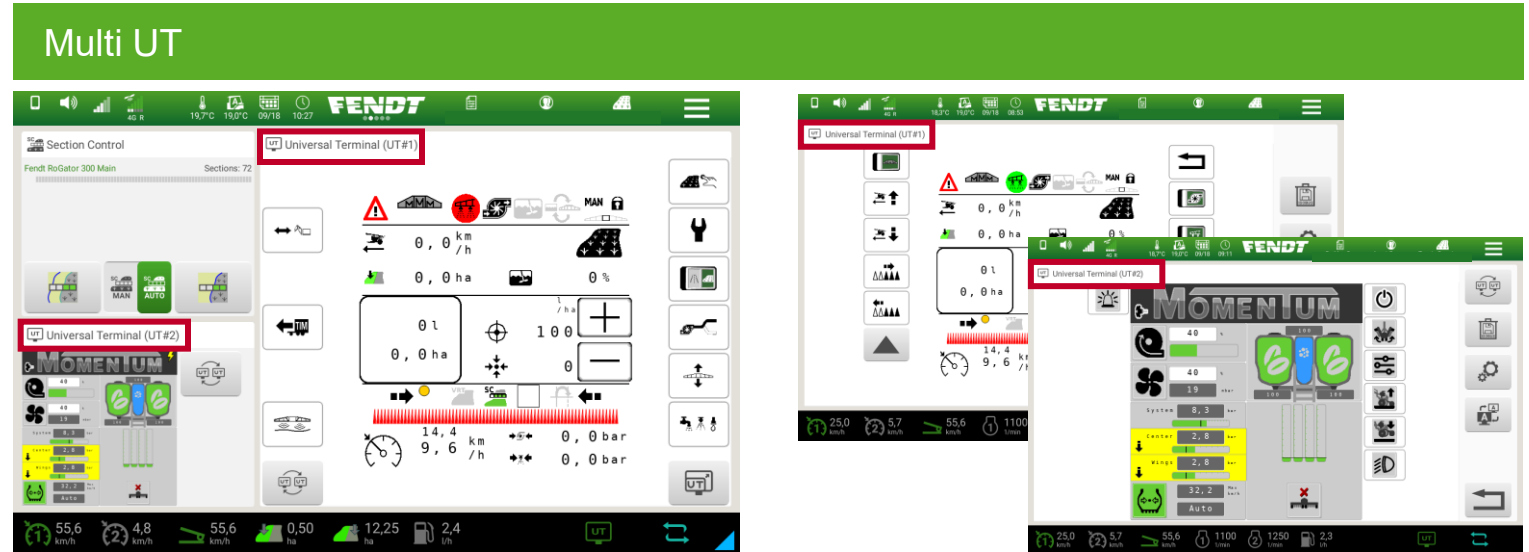

November 2025

So far, two UT screens (Universal Terminal) can be placed on the armrest terminal and the roof terminal, but only one UT screen could be operated and updated at the same time. The other is visible, but does not always update depending on the implement, which has led to confusion or time-consuming jumping back and forth between terminals.

With Multi UT, working with several ISOBUS-capable implements becomes more intuitive, as both UTs (one implement per terminal) are updated simultaneously and continuously. Multi UT increases the quality of work through potential multiple operation of complex implements, e.g. when working with a seed drill at the rear and front tank with fertilizer or a retrofit tire pressure control system and boom guide.

Prerequisite: Rooftop terminal option



Agronomie: Verbesserungen

Agronomy (1)

Customization of field information



November 2025

With the software update, the field manager; field name, customer and operation in the terminal. The information can be created and changed in already existing fields.

Agronomy Base package – Auto Doc 1.0 (Auto Logging)

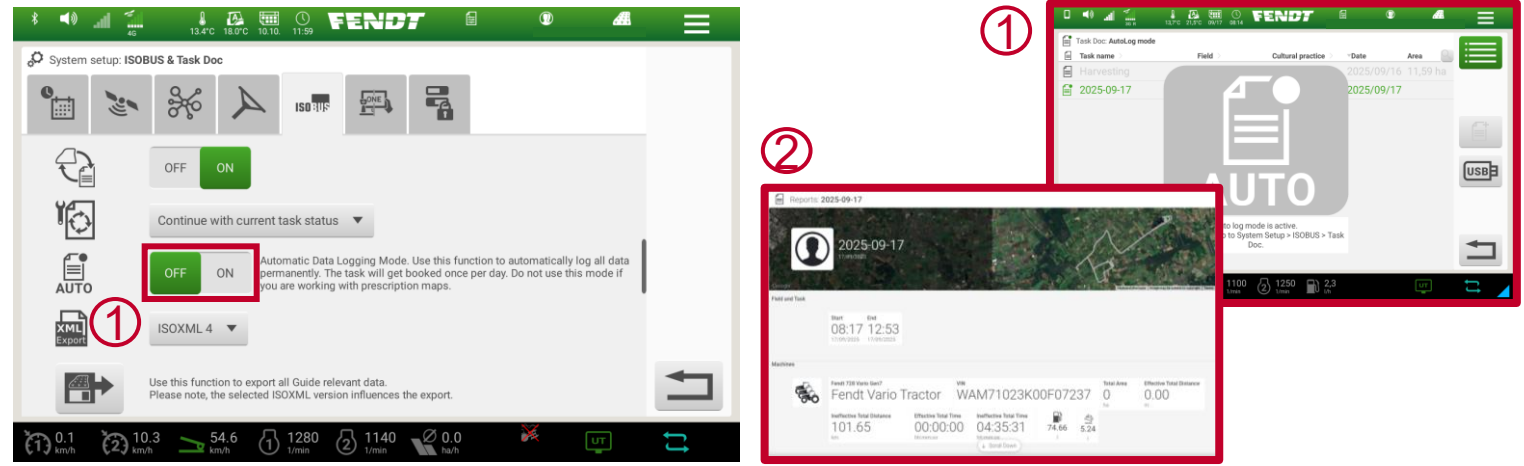

November 2025

A button (1) has been added to System Settings to enable automatic data logging mode directly from the terminal. Previously, this was only possible via a task explicitly created in an FMIS.

Auto logging is a building block in the intelligent, permanent (field-independent) documentation of activities on the machine. With the support of an FMIS portal, the driver no longer has to make manual, active recordings. From the permanent documentation, an FMIS equipped with the range of functions (e.g. Next Farming) can break down the data set into field-specific documentation. In the current FendtONE offboard range of functions, a daily log (i.e. no field-related) documentation is created when the Auto Logging Mode is activated in the terminal (1) (2).

When working with application maps, an order must still be created.

Agronomy (2)

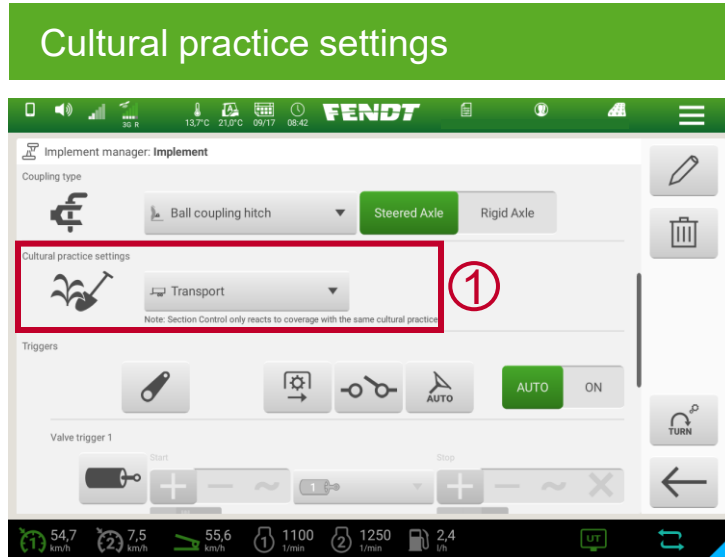

November 2025

In the implement manager of an implement, the setting can be made for working with Section Control that the switching of sections reacts only to the total coverage of the same activity or to all activities.



FendtONE Enabler

Enabler (1)

Front loader ext. display option

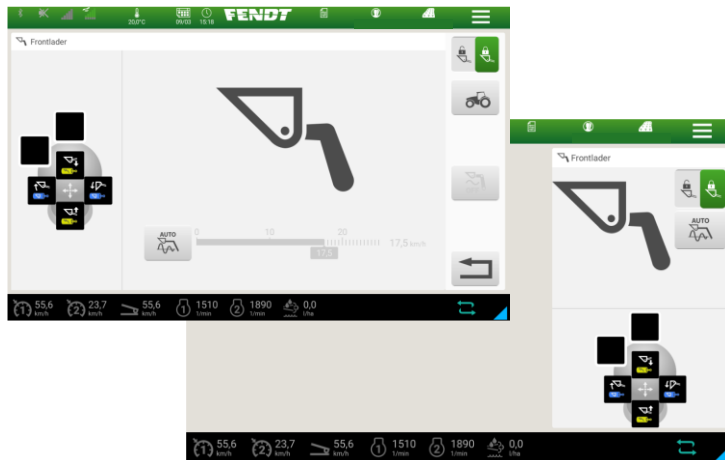

November 2025

The cross gate lever is now displayed with the current function assignment in full-screen mode (1) of the front loader and in the 1x2 tile (2). The screen changes dynamically when changes are made to the assignments in the Assignment Manager.

This makes the current operation of the cross gate lever transparent for the driver at all times and prevents incorrect operation. The display of the 3L joystick is already available.

Differential lock | Freely assignable

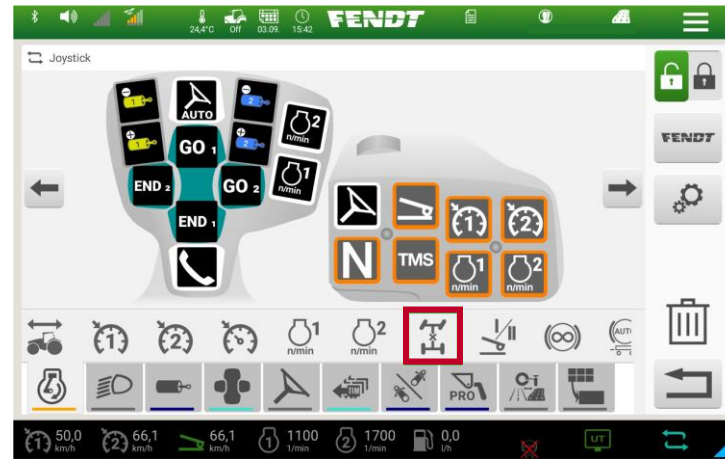

November 2025

The differential lock, which could previously only be activated via the terminal, can be assigned to a freely assignable button on the armrest with the new software version.

The function icon is located in the Engine tab in the Assignment Manager.

Hydraulic brake | Freely assignable

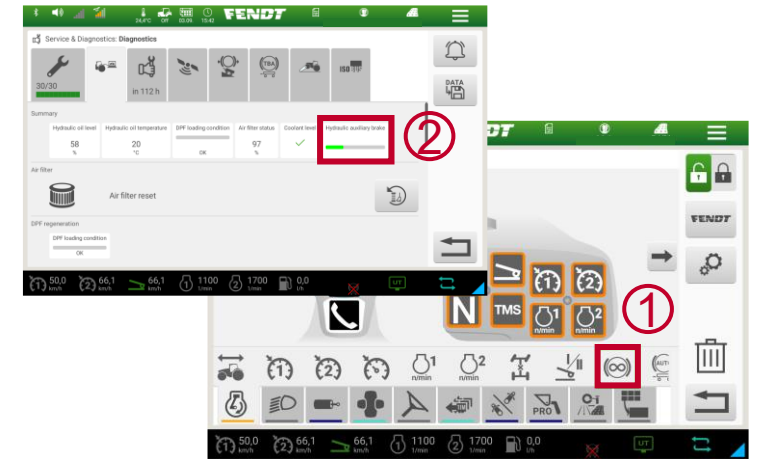

November 2025

Machines equipped with the "hydraulic auxiliary brake" as well as electric tractors with recuperation can now assign this function to the assignable buttons on the armrest and activate it in this way (1). In addition, the status of the auxiliary hydraulic brake (not for recuperation) can be monitored on the service and diagnostics page (2).

The function icon is located in the Engine tab in the Assignment Manager.

Enabler (2)

Noise Cancel Slider



November 2025

For the future integration of smartphones into the FendtONE Terminal (Apple CarPlay), the noise cancellation slider has been removed from the Bluetooth settings.

Feedback Bluetooth Connection

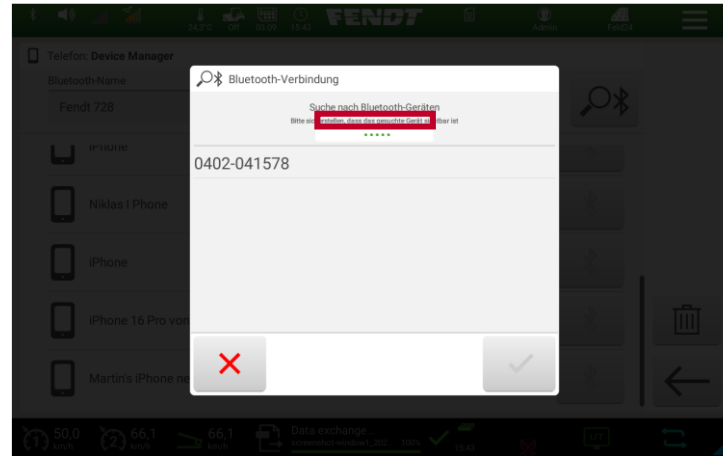

November 2025

In order to give users better feedback while searching for Bluetooth devices in the Fendt terminal, green dots have been implemented to signal the active search process.

QR code explanation videos from Fendt

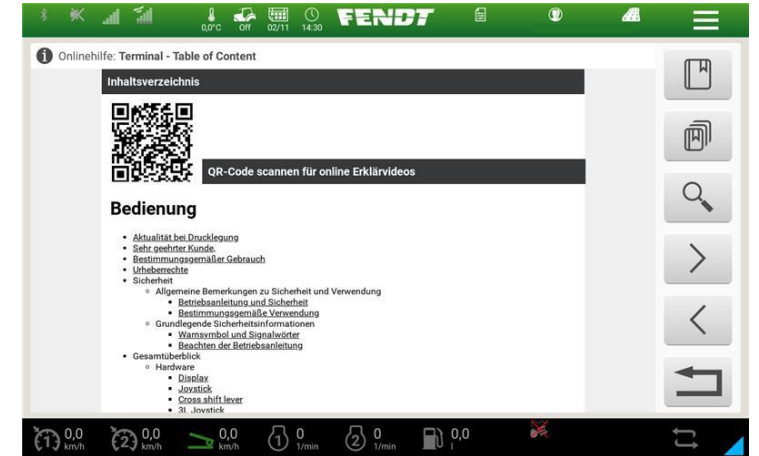

November 2025

In addition to operating instructions via a QR code, Fendt drivers will in future have a contact point for explanatory videos from Fendt.

Enabler (3)

Distance setting for ISOBUS devices

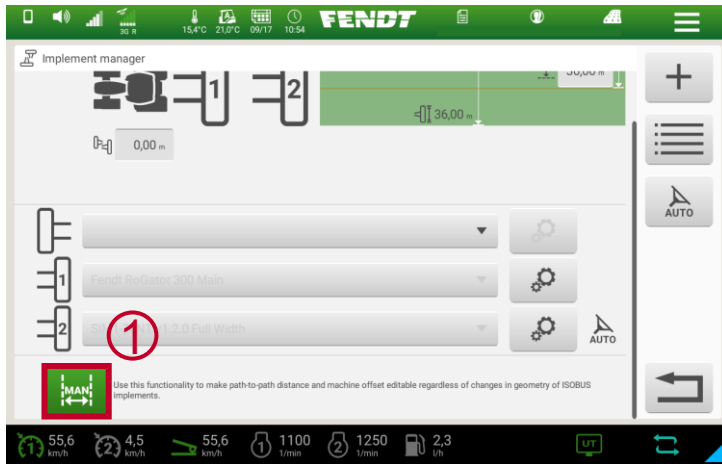

November 2025

Until now, waylines were moved automatically when working with ISOBUS implements as soon as the geometry of the implement was changed, e.g. when lifting a rotor of a multi-rotor rake.

A new button (1) makes it possible to make the working width of ISOBUS implements editable, and thus to drive a constant track line spacing regardless of the working width sent via the ISOBUS of the implement.

New Fendt 800 and 1000 Vario | Setting the lighting concept

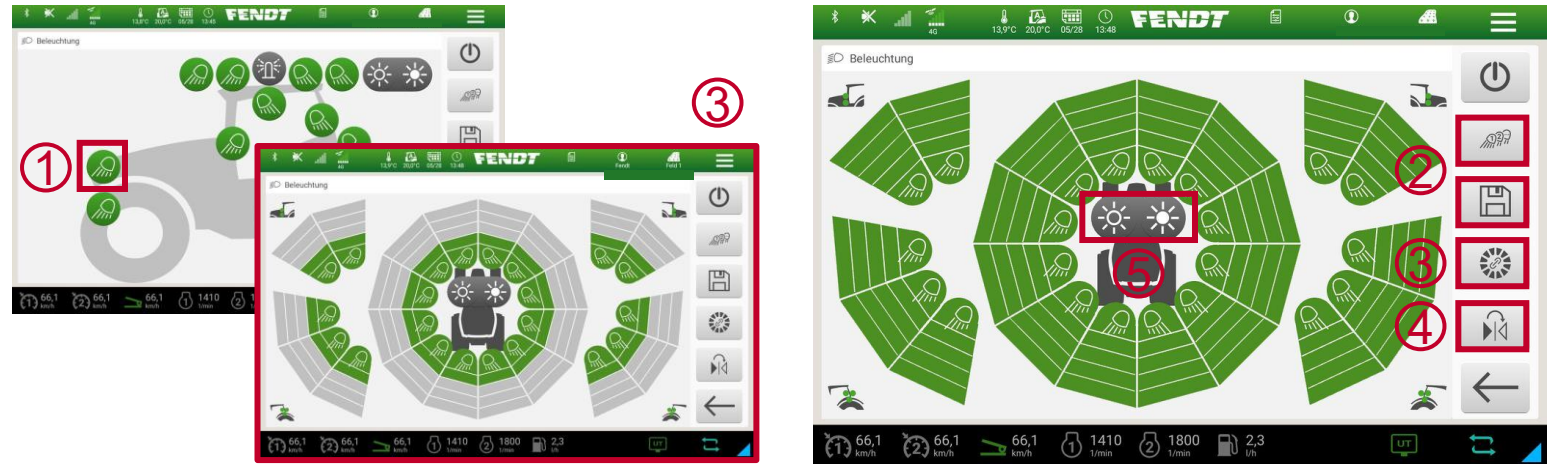

November 2025

The new lighting concept of the 800 and 1000 Vario has resulted in new setting options in the terminal:

- Individual switching on and off of individual cab work lights (1).
- Profiles can be saved for different situations (2) for faster and more comfortable work with the best illumination.
- UltraVision headlights with dimming function (3) for better visibility, e.g. in fog and no dazzling of the drivers of oncoming vehicles.
- Current photograph is transferred to the other side of the tractor, e.g. for driving off during shredding (4).
- All lights can be made one level brighter/darker, regardless of the currently set level (5).

Enabler (4)

Overview of unlocked software products



June 2025

New page (1) under the "General Settings" section, where an overview of the unlocked functions and their remaining runtimes is given.

Pop-Up Activated Software Products

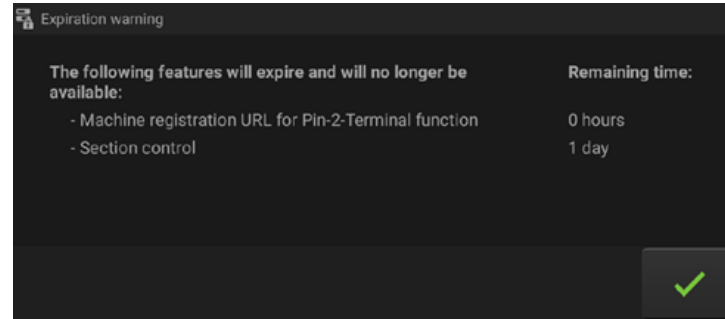

June 2025

New pop-up window that pops up when a temporarily enabled feature expires within the next seven days or the next 24 hours.